

BUILDING DEPT. - VILLAGE OF LYNBROOK  
 P.O. BOX 7021  
 ONE COLUMBUS DRIVE  
 LYNBROOK, NY 11563-7021  
 APPLICATION FOR ERECTION OF FENCE

FEE: \$100.00 CHECK/MONEY ORDER ONLY & TWO (2) COPIES OF SURVEY

Premises where fence is to erected \_\_\_\_\_

Section \_\_\_\_\_ Block \_\_\_\_\_ Plot \_\_\_\_\_ Zoned \_\_\_\_\_

Owner \_\_\_\_\_ Tel.# \_\_\_\_\_

Address of Owner \_\_\_\_\_

Contractor \_\_\_\_\_ Tel.# \_\_\_\_\_

Address of Contractor \_\_\_\_\_

INDICATE LOCATION & HEIGHT OF PROPOSED FENCE:

----- Indicates 6 Ft. Maximum  
 xxxxxxxxx " 4 Ft. Maximum  
 ++++++++ " 3 Ft. Maximum

TYPE OF FENCE

- PVC
- Wood
- Cyclone
- Masonry
- Iron

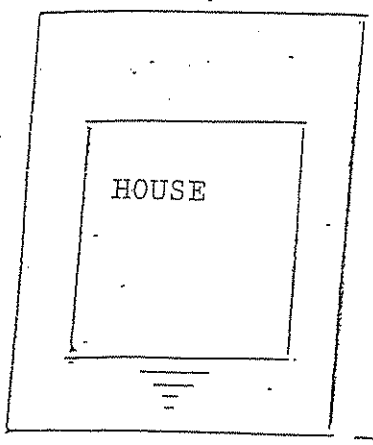

STREET  
 INTERIOR LOT

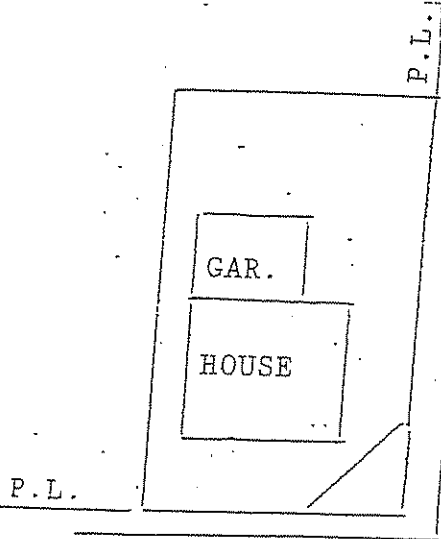

P.L.  
 STREET  
 CORNER LOT

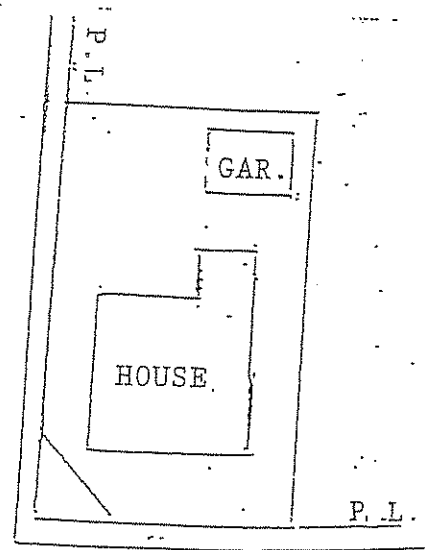

P.L.

Signature of Applicant \_\_\_\_\_

Permit # \_\_\_\_\_

Office Use Only  
 Inspected/Approved \_\_\_\_\_

Issued \_\_\_\_\_

Superintendent-Bldg. Dept

VILLAGE OF LYNNBROOK  
 BUILDING DEPT.  
 ONE COLUMBUS DRIVE  
 LYNNBROOK, NY 11563-7021

BUILDING DEPT. - VILLAGE OF LYNNBROOK  
 P.O. BOX 7021  
 ONE COLUMBUS DRIVE  
 LYNNBROOK, NY 11563-7021  
 APPLICATION FOR ERECTION OF FENCE

FEE: \$100.00 CHECK/MONEY ORDER ONLY & TWO (2) COPIES OF SURVEY

Premises where fence is to erected \_\_\_\_\_

Section \_\_\_\_\_ Block \_\_\_\_\_ Plot \_\_\_\_\_ Zoned \_\_\_\_\_

Owner \_\_\_\_\_ Tel.# \_\_\_\_\_

Address of Owner \_\_\_\_\_

Contractor \_\_\_\_\_ Tel.# \_\_\_\_\_

Address of Contractor \_\_\_\_\_

INDICATE LOCATION & HEIGHT OF PROPOSED FENCE:

----- Indicates 6 Ft. Maximum  
 xxxxxxxxxx " 4 Ft. Maximum  
 ++++++++ " 3 Ft. Maximum

TYPE OF FENCE  
 PVC  
 Wood  
 Cyclone  
 Masonry  
 Iron

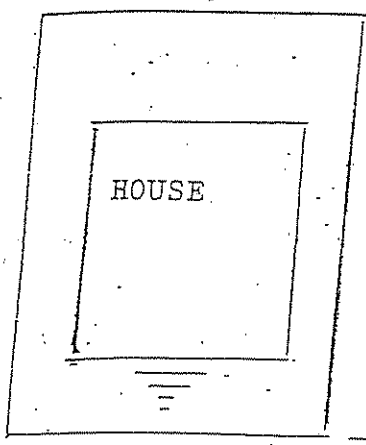

STREET  
 INTERIOR LOT

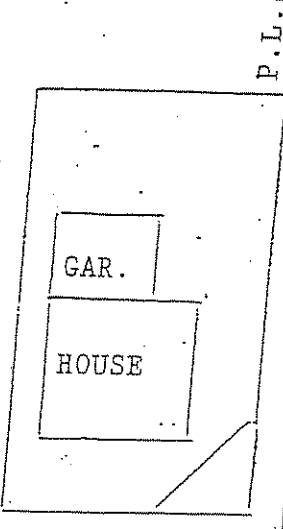

P.L.  
 STREET  
 CORNER LOT

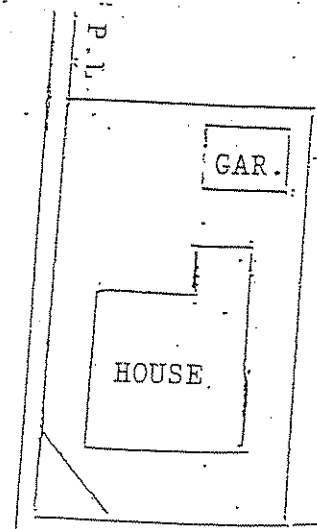

P.L.

Signature of Applicant \_\_\_\_\_

Permit # \_\_\_\_\_

Office Use Only  
 Inspected/Approved \_\_\_\_\_

Issued \_\_\_\_\_

Superintendent-Bldg. Dept

Residential Requirements

Zoning District - Residential A, B & C

----- indicates 6 ft. Maximum  
 XXXXXXXXXXXX " 4 ft. Maximum  
 ++++++++ " 3 ft. Maximum

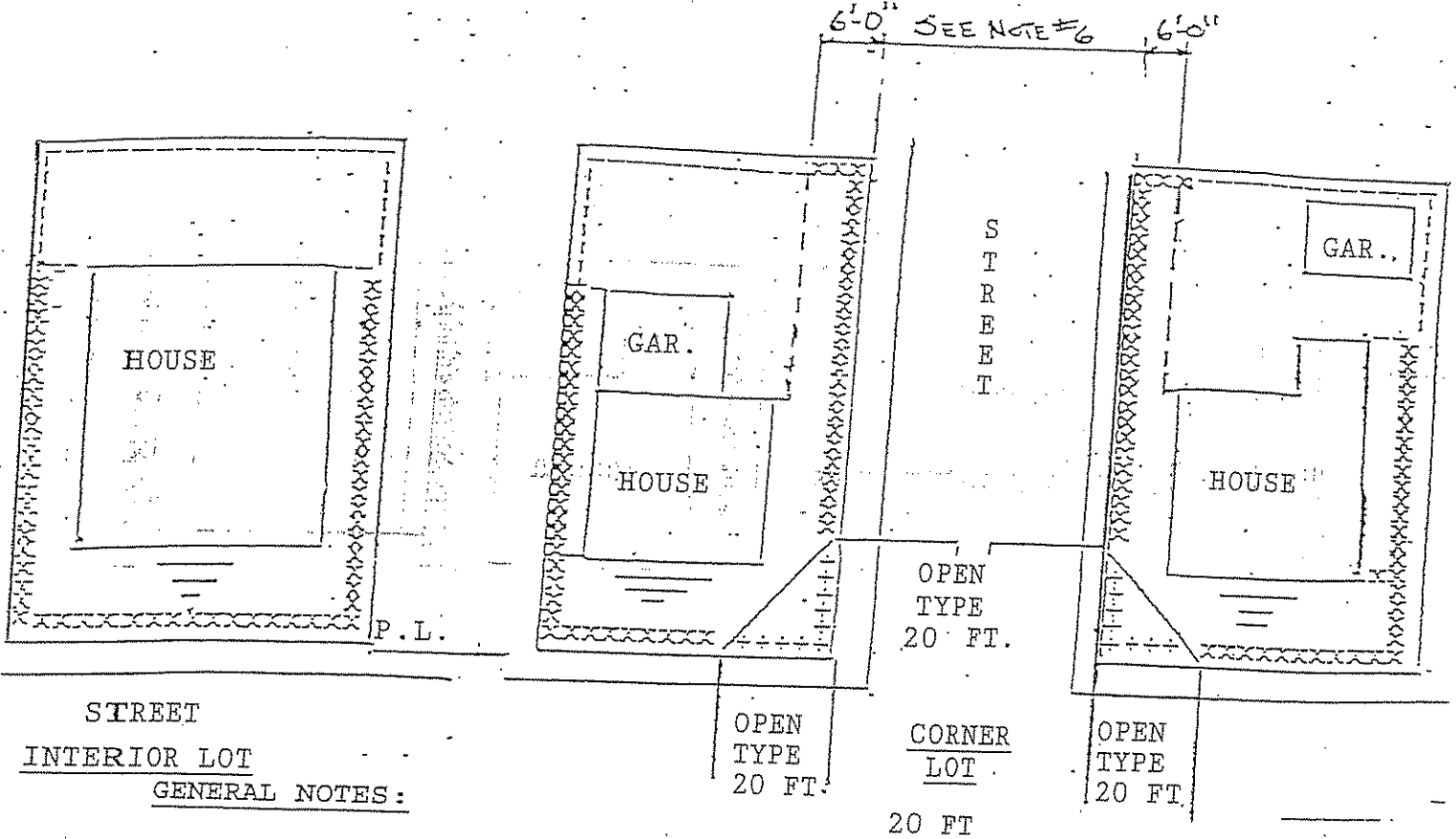

GENERAL NOTES:

1. 2 Copies of survey is required with permit for any 3 foot plus fence.
2. Fence must be located entirely within property lines including concrete footings.
3. Corner fences shall have an open type fence ONLY. (cyclone, picket etc.)
4. Height of fence shall be from natural grade.
5. Finished side, good side or flat/smooth side shall face neighbor or street.
6. 6'0" set back of 6' high fence maybe reduced to two (2) feet with Architectural Board of Review Approval Only.

BUSINESS/COMMERCIAL, LIGHT MANUFACTURING, & INDUSTRIAL DISTRICTS

1. Permits 6 foot maximum fencing.
2. Barbed wire maybe added over owners property (NOT SIDEWALK) only in Light Manufacturing and Industrial Districts.
3. All of the above items indicated in Residential Zoning apply to Commercial EXCEPT for height.

§ 144-5. Height of fences. [Amended 7-12-1976 by L.L. No. 7-1976; 11-6-1978 by L.L. No. 16-1978; 12-7-1981 by L.L. No. 13-1981]

A. [Amended 1-9-1995 by L.L. No. 1-1995] In Dwelling A, Dwelling B and Dwelling C Districts, a fence not exceeding six feet in height shall be permitted on the rear lot line and those linear portions of the side lot lines enclosing a rear yard; provided, however, that the six-foot fence shall not exceed a greater distance frontward to the street than the rear building line. The term "rear building line" shall refer only to the principal structure and shall not include patios, porches or other extensions thereto. Fences for all other lot lines shall not exceed four feet in height. The finished side of the fence shall face the adjoining property.

(1) On a corner lot, any fence on the rear lot line or on the side lot line enclosing the rear yard which fronts or faces a sidewalk or street and which is located less than six feet from the property line shall be subject to the following requirements if such fence, or any portion thereof, exceeds four feet in height:

(a) Prior to the issuance of a permit, the application for such fence shall be submitted to the Architectural Review Board, which shall review the design and aesthetics of such fence.

(b) Such fence shall be set back from the property line not less than two feet; however, the Architectural Review Board may require that such fence be set back up to six feet from the property line if the Board finds that a setback of greater than two feet is required for aesthetic or other reasons.

(c) The Architectural Review Board may require decorative fencing and may require plantings to be installed and maintained on the street side of the fence or may impose other conditions as the Board deems necessary and proper.

§ 144-5

LYNBROOK CODE

§ 144-8

(d) The finished side of such fence shall face the street.

B. A fence, not exceeding six feet in height, shall be permitted in the Commercial, Light Manufacturing and Industrial Districts, as designated on the official Zoning Map of the village. The finished side of the fence shall face the adjoining property.

§ 144-6. Height of fences for schools.

A fence for any public or private school in the village may be erected to a height of six feet above the ground.

§ 144-7. Use of barbed-wire fences. [Amended 3-2-1998 by L.L. No. 6-1998]

Fences in the Light Manufacturing or Industrial Zone may have barbed wire on the tops thereof. Barbed wire shall be completely on the property side of the fence.

§ 144-8. Appeals.

A. Right of appeal. Any owner, lessee or person aggrieved by any order served upon him by the Building Superintendent or by a member of the Police Department with respect to any hedge or fence may make application to the Board of Appeals, within 10 days after such order has been served upon him, to revoke such order or for other relief.

B. Effect of appeal. The operation of any order served shall be suspended pending the hearing thereof by the Board of Appeals, and all operation or contemplated action with reference to a fence, except as herein set forth, shall also be suspended.

C. Authority as to appeal. The Board of Appeals may confirm, revoke or modify any such order and may